



Exchange
for good

— MADE IN ITALY —



TAILOR  **MADE**
HEAT EXCHANGERS
CIPRIANI

GAMMA PRODOTTI / PRODUCT RANGE DN 65+

Standard o Personalizzabili
Standard or Customized



Exchange
for good

TAILOR MADE
HEAT EXCHANGERS
CIPRIANI

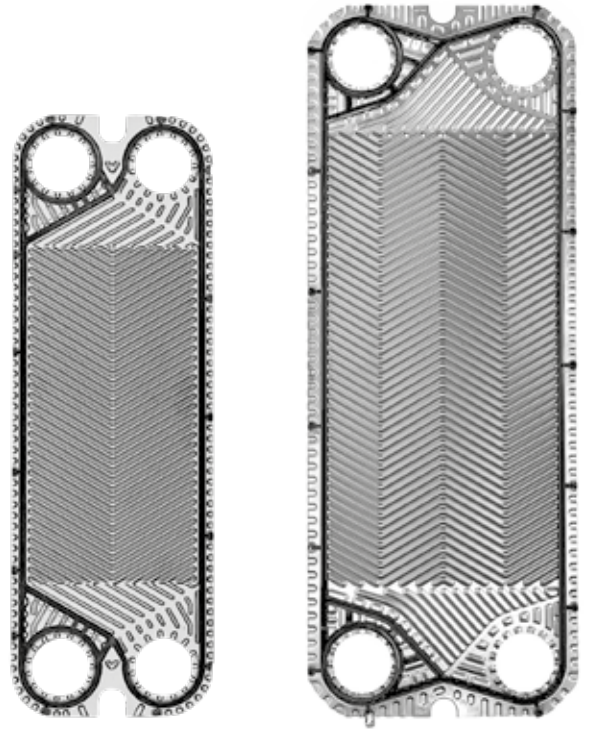

Gamma Prodotti	Product Range	P125+		P180+
Area di scambio [m ²]	Exchange area [m ²]	0,125		0,18
Larghezza [mm]	Width [mm]	245		320
Altezza [mm]	Height [mm]	723		844
Diametro connessioni	Connections diameter	DN65 2"1/2		DN65 2"1/2
Capacità canale [l]	Channel capacity [l]	0,366		0,5
Quota di serraggio [mm]	Tightening quote [mm]	3,3		2,85
Peso piastra (con guarnizione) [Kg]	Plate weight (with gasket) [Kg]	0,69		1,03
Angolo di corrugazione	Corrugation angle	A/B		A/B
Portata max d'acqua [m ³ /h]	Max. water flowrate [m ³ /h]	80		83
PS=> Pressione max di esercizio [bar]	PS=> Max working pressure [bar]	10	16	10

Ex art. 3.3 D.Lgs. 93 del 25/02/2000 in applicazione Direttiva 97/23. I valori di pressione indicati si riferiscono a piastre AISI 316L.
Ex art. 3.3 D.Lgs. 93 of 25/02/2000 in accordance with Directive 97/23/CE. Announced pressions are referred to AISI 316L plates.

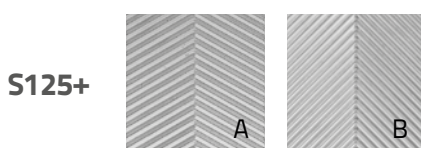

Piastra disponibili in due lunghezze termiche (A/B).
Plates are available in two thermal lengths (A/B).

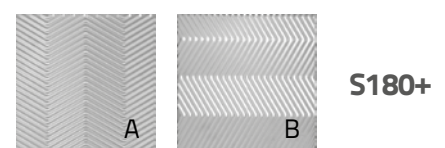

DN32	DN50	DN65	DN100	DN150	DN200
-------------	-------------	-------------	--------------	--------------	--------------

Tutti i dati e disegni nel presente documento possono subire variazioni senza preavviso e non sono vincolanti per il produttore.
All data and drawings herewith described can be changed without prior notice and are not binding for the manufacturer.

DIMENSIONI TELAI / FRAMES DIMENSIONS

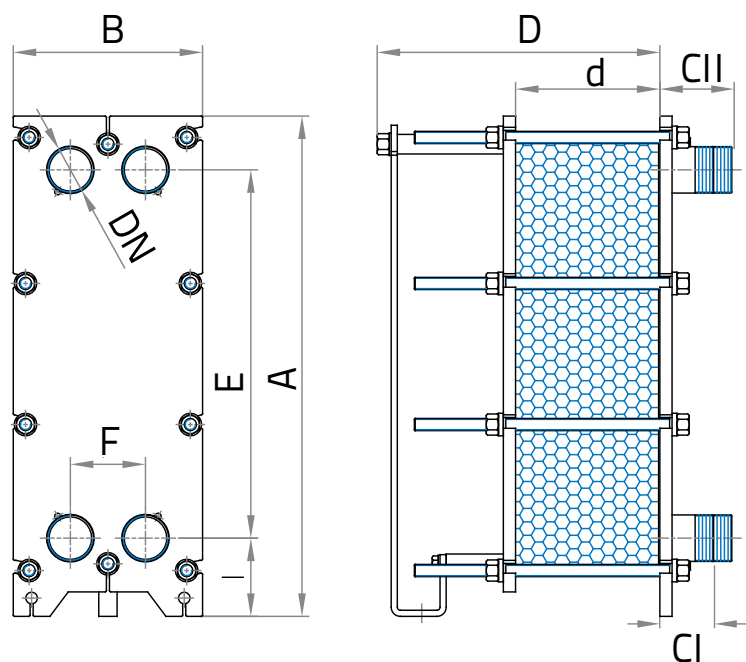

		S125+				S180+			
A		-				J - J	A-A B-B C-C E-E U-U V-V		
		819				996	1030		
B		310				392			
E		603				720			
F		123				192			
I		128				171,5			
Np max		41	71	101	151	41	71	101	151
D max		349	459	599	829	313	443	573	783
d (J-J)		3,3 x Np+2				2,85 x Np+2			
DN		DN65 2"1/2				DN65 2"1/2			
J-J	CI	88				88			
	CII	118				88			
M-M	CI-CII	93				93			
J-M	CI	84				84			
	CII	93				93			
Y-Y	CI	88				88			
	CII	118				88			
X-X K-K	CI	276				-			
	CII	236				-			
A-A B-B C-C E-E U-U V-V	C	-				28			

Tutte le dimensioni sono in mm - Np = numero di piastre. All dimensions are in mm - Np = number of plates.

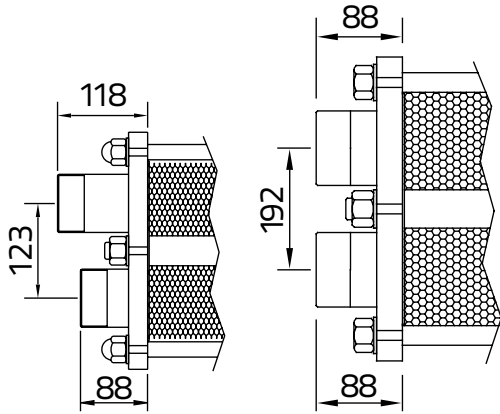

S125+

S180+

J-J

Attacchi mobili filettati maschio in AISI 316.

AISI 316 male threaded connections.

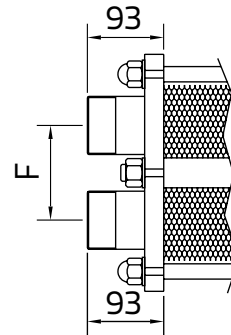

M-M

Attacchi mobili filettati maschio in PP.

PP male threaded connections.

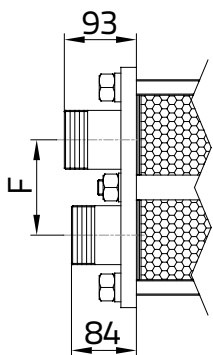

J-M

Attacchi mobili filettati maschio in AISI 316 e PP.

AISI 316 and PP male threaded connections.

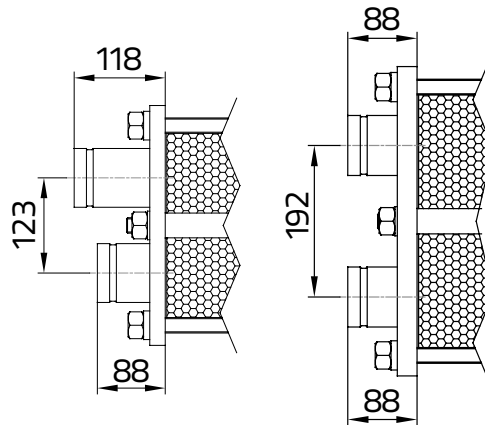

S125+

S180+

Y-Y

Attacchi mobili a estremità scanalata in AISI 316.

AISI 316 grooved pipe connections.

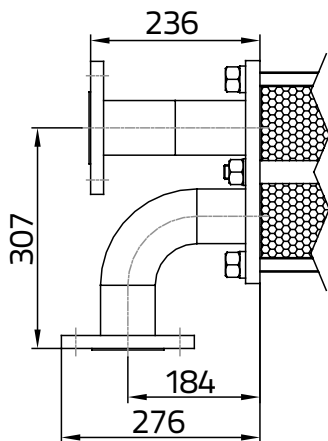

X-X

Flange mobili in acciaio inox AISI 304 (EN 1092-1). Tubo in AISI 316.

AISI 316 pipes with AISI 304 loose flanges EN 1092-1 or ANSI 150lbs.

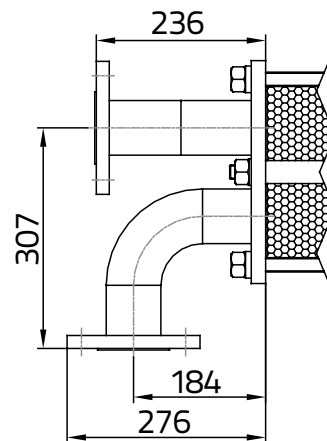

K-K

Flange mobili in acciaio al carbonio verniciato (EN-1092-1). Tubo in AISI 316.

AISI 316 pipes with carbon steel loose flanges EN 1092-1 or ANSI 150lbs.

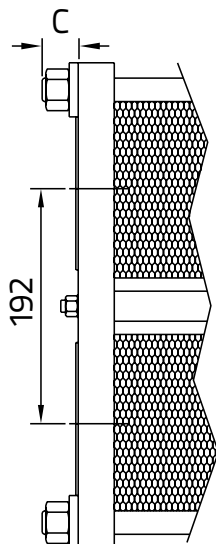

A-A

A flangiare EN 1092-1 con manichette in gomma. Studded ports. Rubber lining. EN 1092-1.

B-B

A flangiare EN 1092-1 con manichette AISI 316. Studded ports. AISI 316 lining. EN 1092-1.

C-C

A flangiare EN 1092-1 senza manichette. Studded ports. Unlined. EN 1092-1.

E-E

A flangiare ANSI (fil. metrica) con manichette in gomma. Studded ports. Rubber lining. ANSI (metric thread).

U-U

A flangiare ANSI (fil. metrica) con manichette AISI316. Studded ports. AISI 316 lining. ANSI (metric thread).

V-V

A flangiare ANSI (fil. metrica) senza manichette. Studded ports. Unlined. ANSI (metric thread).

PIEDINI / FEET

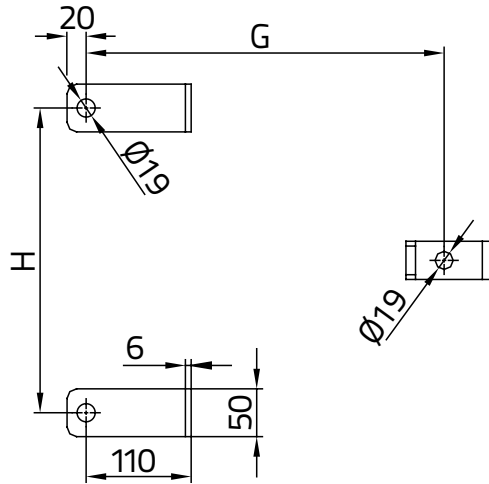

G		H
PS10	PS16	

S125+			
Max 41p	380	385	250
Max 71p	520	540	
Max 101p	660	665	
Max 151p	890	895	
S180+			
Max 41p	375	-	319
Max 71p	505	-	
Max 101p	635	-	
Max 151p	845	-	

MATERIALI / MATERIALS

		S125+	S180+
Piastre Plates	AISI 304	●	●
	AISI 316L	●	●
	254 SMO	●	
	Titanio / Titanium	●	●
Guarnizioni Gaskets	NBR	●	●
	EPDM Prx.	●	●
	FPM	●	
	HNBR	●	
Telai Frames	Acciaio Carbonio / Carbon steel	●	●
	SS 304, pieno / solid	●	●
Attacchi Connections	J-J	●	●
	M-M	●	●
	J-M	●	●
	Y-Y	●	●
	X-X	●	
	K-K	●	
	A-A B-B C-C E-E U-U V-V		●

Materiali guarnizioni e temperature massime Gaskets material maximum temperatures

NBR	-20 °C	110 °C
EPDM Prx.	-20 °C	160 °C
FPM	-20 °C	200 °C
HNBR	-20 °C	160 °C

Le temperature devono essere considerate non applicabili in tutte le condizioni di lavoro.
The temperatures must be considered not applicable in all working conditions.

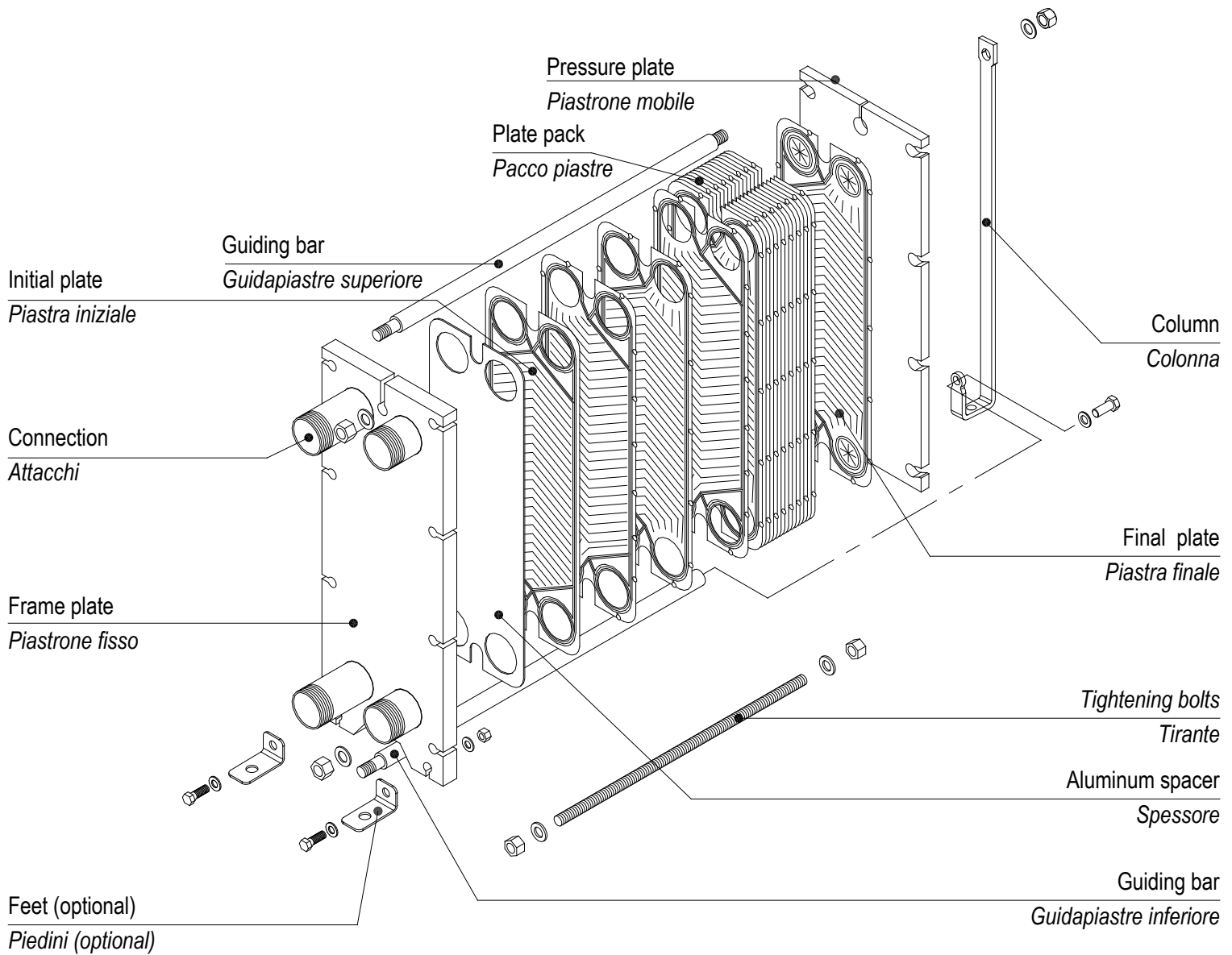

CERTIFICATIONS APPROVALS



▪ ACS
Attestation de Conformité Sanitaire

▪ OHSAS 18001
Occupational Health and Safety

▪ ISO EN 9001:2015
European Quality Certificates

▪ PED 2014/68/UE
Pressure Equipment Directive
Module B,D1 & D (up to Risk Cat. IV)



▪ WRAS
EPDMprx gasket compound approved



▪ ISO 14001
Environmental Management



Exchange
for good

Via Nassar, 46 - 37026 Pescantina (VR)
Tel. +39 045 6750065 • Fax +39 045 6750118
info@cipriani-phe.com
cipriani-phe.com